

Precision Dial Indicators 810

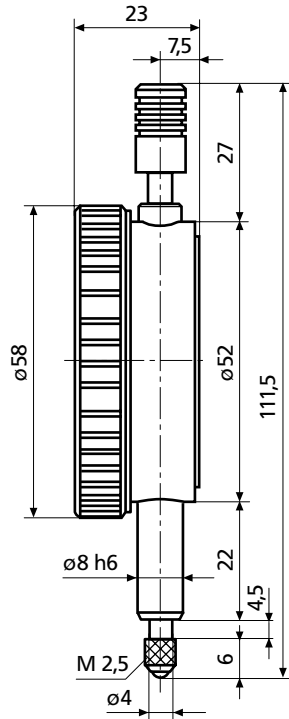

810 AU



810 AX

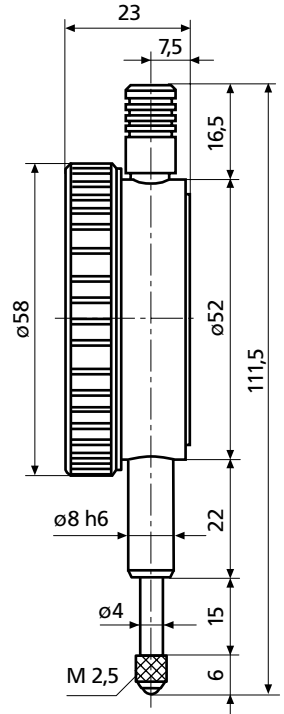

Features

Dial Indicator 810 AU

with a reversed measuring force direction

- Chrome-plated housing
- Adjustable tolerance markers
- Scale on the dial increases counter clockwise (+ on left)
- Measuring force acting towards the top
- Delivered in plastic case

Dial Indicator 810 AX

with reading 0.1 mm

- Constant measuring force
- Chrome-plated housing
- Adjustable tolerance markers
- 1 pointer movement on 10 mm
- Delivered in plastic case

Technical Data

	Range	Readings	Dial face dia.	Overtravel	Mounting shank dia.	Measuring force	Order no.
	mm	mm	mm	mm	mm	N	
810 AU	10	0.01	50	0.1	8h6	1 - 1.8	4329050
810 AX	10	0.1	50	0.5	8h6	0.9 - 1.3	4331000
810 V	40	0.01	50	0.3	8h6	0.9 - 2.0	4321110
810 AG	10	0.01	108	0.1	8h6	1.3 - 2.2	4322000

Precision Dial Indicators 810

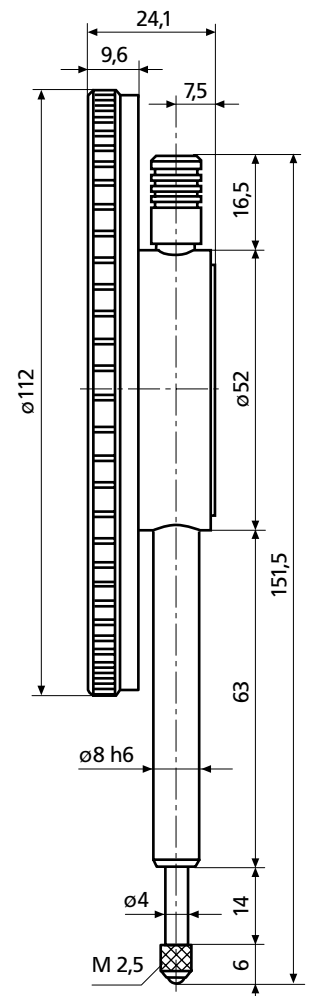
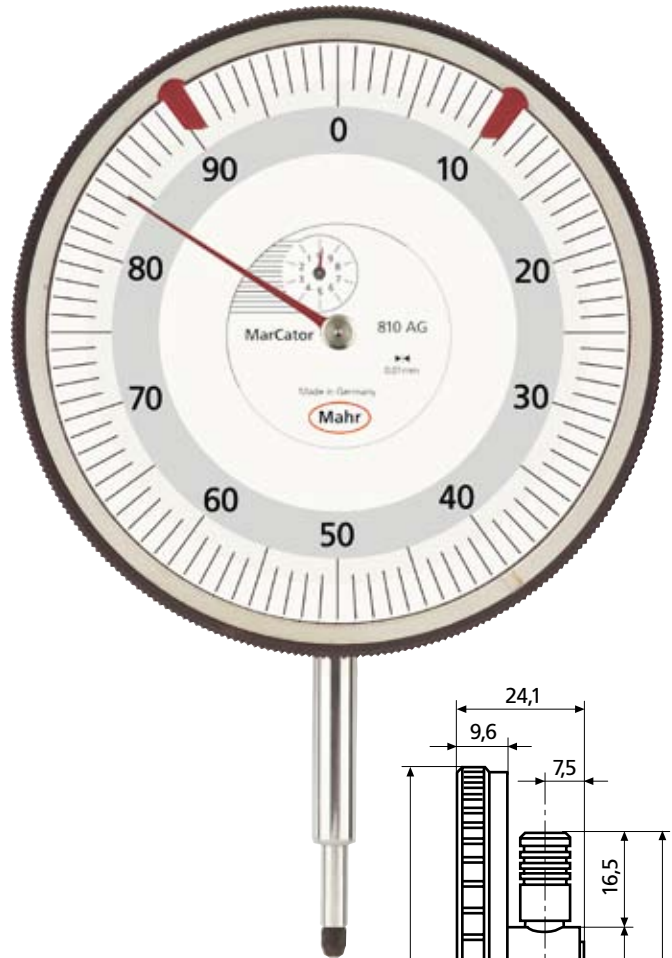
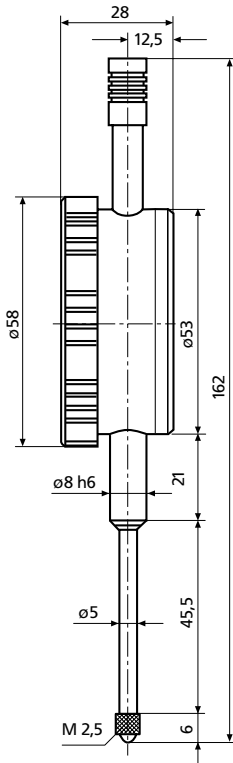

Features

Long Range Dial Indicator 810 V

with larger measuring range

- Range 40 mm
- Strengthened measuring spindle (5 mm)
- Raising of measuring spindle via lifting cap
- Adjustable tolerance markers
- Shockproof movement
- Delivered in folded box

Extra large Dial Indicator 810 AG

with dial face dia. 108 mm

- Ideal for long reading distance and in bad light conditions
- Plastic outer ring
- Delivered in folded box

Accessories

Order no.

Adapter Bush for adapting mounting shank 8h6 mm to inch bore .375"

940 4310103

Splash Guard Cover for dia. 58 mm

955 4373020

Mounting Lug to mount on mounting shank of all versions

963 4375002

Contact Points and Accessories for Dial Indicators, Dial Comparators and Probes

Standard Contact Points 901

Ball dia. 3 mm

Catalog no.		Order no.
901	with steel ball	4360001
901 H	with carbide ball	4360002
901 R	with ruby ball	4360003

Spherical Contact Points 902 Flat Contact Points 903

902	902 H	903	903 H
Steel	Carbide contact face	Steel	Carbide tipped
Length mm	Order no.	Order no.	Order no.
4	4360007	-	4360070
6	4360009	-	4360071
8	4360010	4360040	4360072
10	4360011	4360041	4360073
12	4360012	4360042	4360074
15	4360013	4360043	4360075
20	4360014	4360044	4360076
25	4360015	4360045	4360077
30	4360016	4360046	4360300
35	4360017	4360047	4360078
40	4360019	4360049	4360310
45	4360026	4360050	4360303
50	4360018	4360048	4360079
55	4360031		
65	4360035		
75	4360020		
85	4360036		
95	4360029		

Ball Contact Point 906 H

with carbide ball. accuracy ball dia. 0/-6µm

Ball dia. d mm	l mm	Order no.	Ball dia. d mm	l mm	Order no.
1	8.5	4360150	5.5	9	4360161
1.25	8.5	4360151	6	9	4360162
1.5	8.5	4360152	6.35 (1/4")	9	4360163
1.75	8.5	4360153	6.5	10	4360164
2	8.5	4360154	7	10	4360165
2.5	8.5	4360155	7.5	11	4360166
3	8.5	4360156	8	11	4360167
3.5	8.5	4360157	8.5	12	4360168
4	8.5	4360158	9	12	4360169
4.5	8.5	4360159	10	13	4360170
5	9	4360160			

Contact Rollers 909

Concentricity error 3 µm

	Order no.
Cylindrical Roller	909 A 4360220
Radiused Roller, R = 5 mm	909 B 4360221

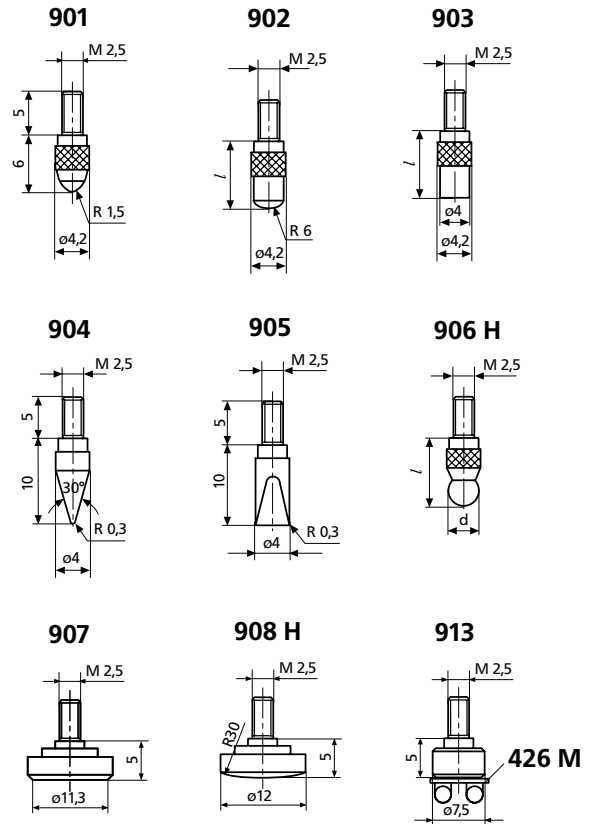

Special Contact Points

	Order no.
Conical Contact Points, Steel	904 4360130
Carbide tipped	904 H 4360131
Wedge Shaped Contact Points, Steel	905 4360140
Carbide tipped	905 H 4360141
Flat Contact Points, Steel, A = 1 cm²	907 4360200
Carbide tipped, dia. 7 mm	907 H 4360201
Spherical Contact Points, Steel	908 4360210
Carbide tipped	908 H 4360211
Flat Contact Point, for mounting Pin Gage Holder 426 M for measuring threads using three-wire method	913 4360400

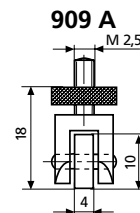

Contact Points and Accessories for Dial Indicators, Dial Comparators and Probes

Measuring Attachment 910 H

	Order no.
with parallel adjustable carbide blades	910 H 4360230

Pin Contact Point 911

dia. 1 mm, flat

Length l mm	Order no.	Length l mm	Order no.
15	4360280	35	4360284
20	4360281	40	4360285
25	4360282	50	4360286
30	4360283		

Pin Contact Point 911 H

	Order no.
Carbide tipped, dia 1 mm, flat	911 H1 4360240
Carbide tipped, dia 1.5 mm, flat	911 H2 4360241

Measuring Spindle Extensions 912

Length l mm	Order no.	Length l mm	Order no.
10	4360250	35	4360254
15	4360251	50	4360255
20	4360252	75	4360256
25	4360253	100	4360257

Special Holder 941

For all types of measuring equipment
 For placing a dial indicator at a certain distance or angle
 Travel of the measuring spindle 3 mm
 Contact Point 901 (interchangeable)

Straight Holder 941 G

Mounting shank length l_1

Order no.
4365000
4365001
4365002

Angular Holder 941 W

Order no.	l_2	Order no.	l_2	Order no.	l_2
Angle $\alpha=45^\circ$	53.7	Angle $\alpha=60^\circ$	49.3	Angle $\alpha=90^\circ$	34.5
Order no.		Order no.		Order no.	
4365010		4365020		4365030	
4365011	4365021	4365031			
4365012	4365022	4365032			

Sensor Level 943

	Order no.
For testing concentricity in bore holes as well as difficult to reach outside diameters To be inserted in a measuring stand with a lifting device Contact Point 901 interchangeable Travel ± 1 mm	4367000

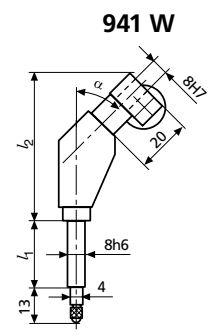
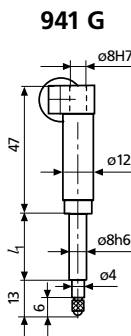
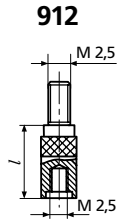
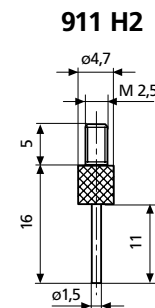
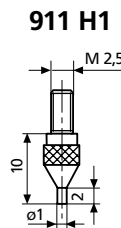
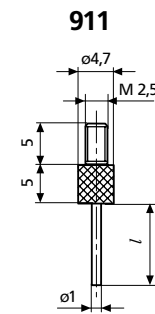
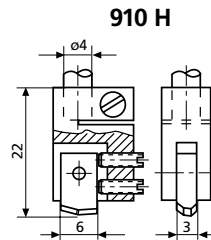

Transmission error with the 941 W
 max. 1%;
 for travel 3 mm = 0.03 mm

