

Futtertyp / Chucktype: **BB-210**
 Hersteller / Maker: **Kitagawa**
 Nutbreite / Slot width: **16 mm**
 Verzahnung / Serration: **1,5x60°**

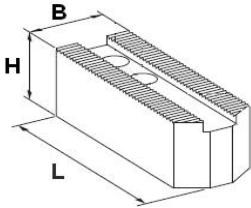

Angespitzt / pointed



Weiche Aufsatzbacken / Soft Top Jaws					Satz = 3 Stück / Set = 3 pieces
L	B	H	kg	article no.	
110	40	40	3.30	KSJ-10-P	
125	40	40	3.90	KSJ-10L-125-P	
110	45	45	4.95	KSJ-10W-45x45-P	
125	40	60	5.70	KSJ-10L-125-P	
110	40	80	7.20	KSJ-08H-80-P	

Flach / Flat

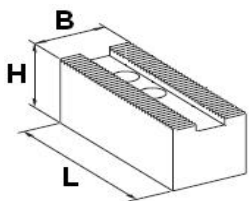

Weiche Aufsatzbacken / Soft Top Jaws					Satz = 3 Stück / Set = 3 pieces
L	B	H	kg	article no.	
110	50	50	5.40	KSJ-10W-50x50-F	
110	60	40	5.10	KSJ-10W-60x40-F	
110	60	60	8.10	KSJ-10W-60x60-F	
110	80	40	6.90	KSJ-10W-80x40-F	
110	40	60	5.10	KSJ-10H-60-F	
110	40	100	8.25	KSJ-10H-100-F	

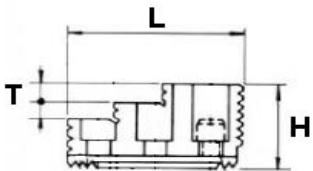

Gehärtete umkehrbare Stufenbacken / Hard top reversible jaws step type						Satz = 3 Stück / Set = 3 pieces
L	B	H	T	kg	article no.	
99.5	40	54	13	2.80	HB10A1	

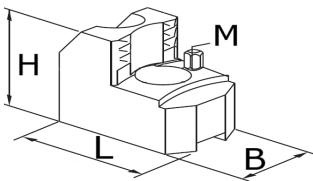

Gehärtete Greiferbacken / Hard top gripper jaws							Satz = 3 Stück / Set = 3 pieces
L	B	H	M	Spannbereich / gripping range	kg	article no.	
105	40	49	M8	40-80 mm	2.40	KGJ-10-4080	
90	40	49	M8	80-120 mm	2.30	KGJ-10-8012	
80	45	58	M8	120-160 mm	2.65	KGJ-10-1216	
80	50	58	M8	160-200 mm	2.70	KGJ-10-1620	
108	60	65	M10	200-254 mm	2.80	KGJ-10-2028	

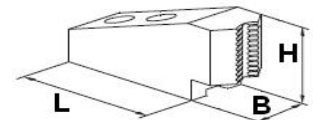

Gehärtete Greiferbacken für kleine Durchmesser / Hard top gripper jaws for small diameters						Satz = 3 Stück / Set = 3 pieces
L	B	H	Spannbereich / gripping range	kg	article no.	
111	40	50	4-20 mm	3.90	KGJ-10-0420	
105	40	50	20-45 mm	3.60	KGJ-10-2045	

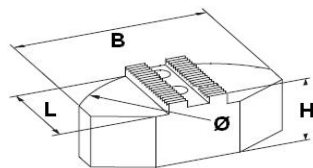

Segmentbacken, Ø 3 Backen = 250mm / Pie Jaws Ø 3 Jaws = 250mm					Satz = 3 Stück / Set = 3 pieces
L	B	H	Material	kg	article no.
90	180	60	Stahl / steel	12.30	KPJ-10
90	180	78	Aluminium	6.70	KPJ-10-A

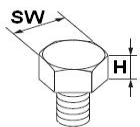

Auflagebolzen M8 (M10) / Screws for gripper jaws M8 (M10)					Satz = 3 Stück / Set = 3 pieces
H	SW	Gewinde / thread	kg	article no.	
5	13	M8 / (M10)	0.04	KWS-58 (KWS-510)	
10	13	M8 / (M10)	0.06	KWS-108 (KWS-1010)	
15	13	M8 / (M10)	0.07	KWS-158 (KWS-1510)	
20	13	M8 / (M10)	0.08	KWS-208 (KWS-2010)	

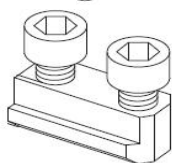

Doppelte Nutensteine passend für BB-210 / Double T-Nuts for BB-210		Satz = 3 Stück / Set = 3 pieces
kg	article no.	
0.36	TNS-BB210	

Version :07/2013

Druckfehler, Irrtümer und Änderungen vorbehalten / Misprints and errors excepted

kitagawa **EUROPE** **BB210** **Accessories**



Chuck size	10" (254mm)
Bore size	81mm
Gripping force kN (kgf)	126 (12848)
Jaw stroke (diameter)	8.8mm
Plunger Stroke	19mm
Matching cylinder	SS1881

Part	Description	
EJ-BB210	Dust Cover Ejector	
BUNG-BB210	Chuck Bung	
KJB-10 KTL-160	Jaw Boring Ring	
GREASE 400g	400g Grease Cartridge	
GUN-K5PRO	Grease Gun	
KGFM-72	Dynamic Grip Meter 72mm	
KGFM-125	Dynamic Grip Meter 125mm	
DN-BB210	Blank Drawtube Connector	
DR-BB210	Threaded Drawtube Connector	
CV-BB210	Cover Plate	