

Futtertyp / Chucktype: **BB-208**
 Hersteller / Maker: **Kitagawa**
 Nutbreite / Slot width: **14 mm**
 Verzahnung / Serration: **1,5x60°**

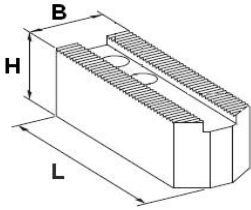

Angespitzt / pointed



Weiche Aufsatzbacken / Soft Top Jaws					Satz = 3 Stück / Set = 3 pieces
L	B	H	kg	article no.	
95	35	35	2.10	KSJ-08-P	
102	35	40	2.70	KSJ-08L-102-P	
120	40	40	3.90	KSJ-08L-120-P	
95	40	40	2.85	KSJ-08W-40x40-P	
95	50	50	4.50	KSJ-08W-50x50-P	
95	35	50	3.30	KSJ-08H-50-P	
95	35	60	3.45	KSJ-08H-60-P	
95	35	80	4.80	KSJ-08H-80-P	

Flach / Flat

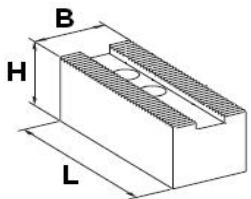

Weiche Aufsatzbacken / Soft Top Jaws					Satz = 3 Stück / Set = 3 pieces
L	B	H	kg	article no.	
95	35	35	2.10	KSJ-08-F	
95	60	40	3.60	KSJ-08W-60x40-F	
95	35	100	5.55	KSJ-08H-100-F	
95	35	120	6.30	KSJ-08H-120-F	

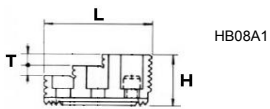

Gehärtete umkehrbare Stufenbacken / Hard top reversible jaws step type						Satz = 3 Stück / Set = 3 pieces
L	B	H	T	kg	article no.	
92	35	51	18	1.90	HB08B1	
86	35	51	12	1.80	HB08A1	

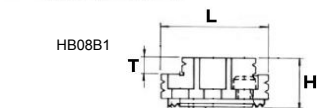

Gehärtete Greiferbacken / Hard top gripper jaws						Satz = 3 Stück / Set = 3 pieces
L	B	H	Spannbereich / gripping range	kg	article no.	
91	35	49	30-60 mm	2.00	KGJ-08-3060	
80	35	49	60-90 mm	1.80	KGJ-08-6090	
68	40	58	90-120 mm	1.65	KGJ-08-9012	
65	40	58	120-150 mm	1.94	KGJ-08-1215	
89	45	59	150-210 mm	2.00	KGJ-08-1521	

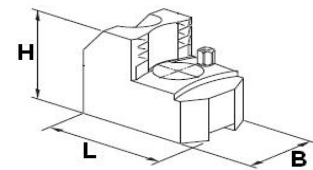

Gehärtete Greiferbacken für kleine Durchmesser / Hard top gripper jaws for small diameters						Satz = 3 Stück / Set = 3 pieces
L	B	H	Spannbereich / gripping range	kg	article no.	
94	35	46	4-15 mm	1.45	KGJ-08-0415	
90	35	49	15-35 mm	1.35	KGJ-08-1535	

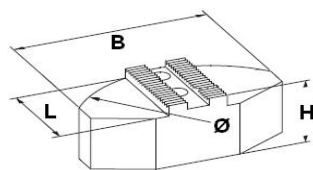
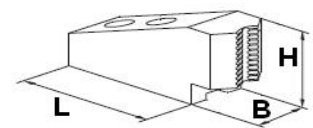

Segmentbacken, Ø 3 Backen = 210mm / Pie Jaws Ø 3 Jaws = 210mm						Satz = 3 Stück / Set = 3 pieces
L	B	H	Material	kg	article no.	
75	140	50	Stahl / steel	6.90	KPJ-08	
75	140	50	Aluminium	3.00	KPJ-08-A	

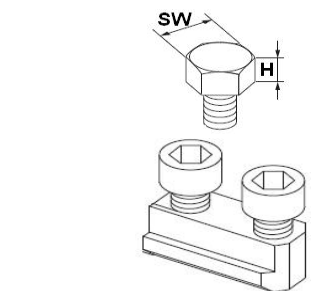

Auflagebolzen M6 / Screws for gripper jaws M6				Satz = 3 Stück / Set = 3 pieces
H	SW	kg	article no.	
5	10	0.03	KWS-56	
10	10	0.04	KWS-106	
15	10	0.04	KWS-156	
20	10	0.06	KWS-206	

Doppelte Nutensteine passend für BB-208 / Double T-Nuts for BB-208		Satz = 3 Stück / Set = 3 pieces
kg	article no.	
0.24	TNS-BB208	

Version : 07/2013

Druckfehler, Irrtümer und Änderungen vorbehalten / Misprints and errors excepted

Kitagawa

EUROPE

BB208

Accessories



Chuck size	8" (210mm)
Bore size	66mm
Gripping force kN (kgf)	99 (10095)
Jaw stroke (diameter)	7.4mm
Plunger Stroke	16mm
Matching cylinder	SS1666

Part	Description	
EJ-BB208	Dust cover ejector	
BUNG-BB208	Chuck Bung	
KJB-08 KTL-125	Jaw Boring Ring	
GREASE 400g	400g Grease cartridge	
GUN-K5PRO	Grease Gun	
KGFM-72	Dynamic Grip Meter 72mm	
KGFM-125	Dynamic Grip Meter 125mm	
DN-BB208	Blank Drawtube Connector	
DR-BB208	Threaded drawtube connector	
CV-BB208	Cover Plate	