

Futtertyp / Chucktype: **BB-206**
 Hersteller / Maker: **Kitagawa**
 Nutbreite / Slot width: **12 mm**
 Verzahnung / Serration: **1,5x60°**

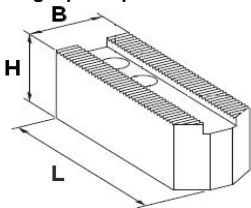

Angespitzt / pointed



Weiche Aufsatzbacken / Soft Top Jaws

L	B	H	kg	article no.
72	30	30	0.90	KSJ-06-P
81	30	30	1.20	KSJ-06L-82-P
72	35	35	1.35	KSJ-06W-35x35-P
72	50	50	3.60	KSJ-06W-50x50-P
72	30	50	1.80	KSJ-06H-50-P
72	30	60	1.95	KSJ-06H-60-P

Satz = 3 Stück / Set = 3 pieces

Flach / Flat

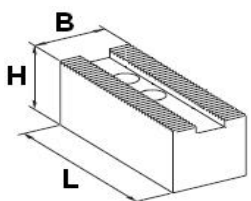

Weiche Aufsatzbacken / Soft Top Jaws

L	B	H	kg	article no.
72	30	30	0.90	KSJ-06-F
72	30	80	2.70	KSJ-06H-80-F
72	30	100	3.30	KSJ-06H-100-F

Satz = 3 Stück / Set = 3 pieces

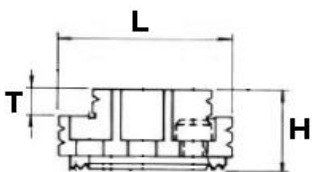

Gehärtete umkehrbare Stufenbacken / Hard top reversible jaws step type

L	B	H	T	kg	article no.
67.5	31	35	12	0.90	HB06B1

Satz = 3 Stück / Set = 3 pieces

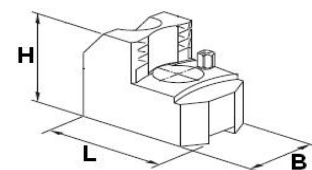

Gehärtete Greiferbacken / Hard top gripper jaws

L	B	H	Spannbereich / gripping range	kg	article no.
76	30	40	30-50 mm	1.00	KGJ-06-3050
68	30	40	50-70 mm	0.90	KGJ-06-5070
63	35	50	70-90 mm	1.10	KGJ-06-7090
58	40	50	90-110 mm	1.50	KGJ-06-9011
63	40	50	110-130 mm	1.60	KGJ-06-1113

Satz = 3 Stück / Set = 3 pieces

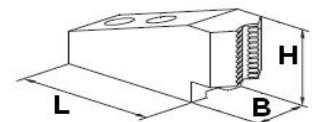

Gehärtete Greiferbacken für kleine Durchmesser / Hard top gripper jaws for small diameters

L	B	H	Spannbereich / gripping range	kg	article no.
79	30	40	4-15 mm	1.30	KGJ-06-0415
75	30	40	15-30 mm	1.20	KGJ-06-1530

Satz = 3 Stück / Set = 3 pieces

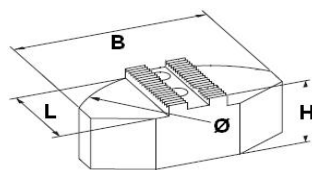

Segmentbacken, Ø 3 Backen = 165mm / Pie Jaws Ø 3 Jaws = 165mm

L	B	H	Material	kg	article no.
60	120	40	Stahl / steel	3.20	KPJ-06
60	120	49	Aluminium	1.70	KPJ-06-A

Satz = 3 Stück / Set = 3 pieces

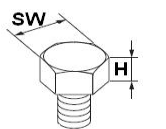

Auflagebolzen M6 / Screws for gripper jaws M6

H	SW	kg	article no.
5	10	0.03	KWS-56
10	10	0.04	KWS-106
15	10	0.04	KWS-156
20	10	0.06	KWS-206

Satz = 3 Stück / Set = 3 pieces

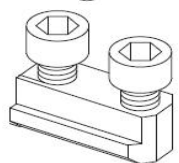

Doppelte Nutensteine passend für BB-206 / Double T-Nuts for BB-206

kg	article no.
0.15	TNS-BB206

Satz = 3 Stück / Set = 3 pieces

Version : 07/2013

Druckfehler, Irrtümer und Änderungen vorbehalten / Misprints and errors excepted

Kitagawa

EUROPE

BB206

Accessories



Chuck size	6" (169mm)
Bore size	53mm
Gripping force kN (kgf)	58.5 (5965)
Jaw stroke (diameter)	5.5mm
Plunger Stroke	12mm
Matching cylinder	SS1453

Part	Description	
EJ-BB206	Dust cover ejector	
BUNG-BB206	Chuck Bung	
KJB06, KTL-100	Jaw Boring Ring	
GREASE 400g	400g Grease cartridge	
GUN-K5PRO	Grease Gun	
KGFM-72	Dynamic Grip Meter 72mm	
KGFM-125	Dynamic Grip Meter 125mm	
DN-BB206	Blank Drawtube Connector	
DR-BB206	Threaded drawtube connector	
CV-BB206	Cover Plate	