

Futtertyp / Chucktype: **B-210**  
 Hersteller / Maker: **Kitagawa**  
 Nutbreite / Slot width: **16 mm**  
 Verzahnung / Serration: **1,5x60°**

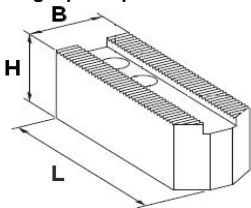

**Angespitzt / pointed**



**Weiche Aufsatzbacken / Soft Top Jaws**

L	B	H	kg	article no.
110	40	40	3.30	KSJ-10-P
125	40	40	3.90	KSJ-10L-125-P
110	45	45	4.95	KSJ-10W-45x45-P
125	40	60	5.70	2645-L
110	40	80	7.20	KSJ-10H-80-P

**Flach / Flat**

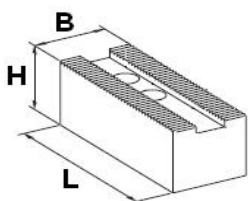

**Weiche Aufsatzbacken / Soft Top Jaws**

L	B	H	kg	article no.
110	50	50	5.40	KSJ-10W-50x50-F
110	60	40	5.10	KSJ-10W-60x40-F
110	60	60	8.10	KSJ-10W-60x60-F
110	80	40	6.90	KSJ-10W-80x40-F
110	40	60	5.10	KSJ-10H-60-F
110	40	100	8.25	KSJ-10H-100-F

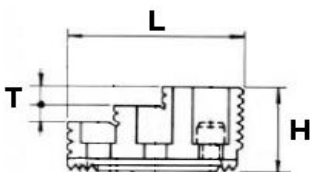

**Gehärtete umkehrbare Stufenbacken / Hard top reversible jaws step type**

L	B	H	T	kg	article no.
99.5	40	54	13	8.40	HB10A1

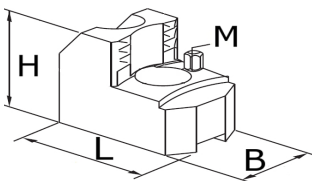

**Gehärtete Greiferbacken / Hard top gripper jaws**

L	B	H	M	Spannbereich / gripping range	kg	article no.
105	40	49	M8	40-80 mm	2.40	KGJ-10-4080
90	40	49	M8	80-120 mm	2.30	KGJ-10-8012
80	45	58	M8	120-160 mm	2.65	KGJ-10-1216
80	50	58	M8	160-200 mm	2.70	KGJ-10-1620
108	60	65	M10	200-254 mm	2.80	KGJ-10-2028

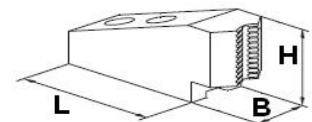

**Gehärtete Greiferbacken für kleine Durchmesser / Hard top gripper jaws for small diameters**

L	B	H	Spannbereich / gripping range	kg	article no.
110	40	50	4-20 mm	3.90	KGJ-10-0420
105	40	50	20-45 mm	3.60	KGJ-10-2045

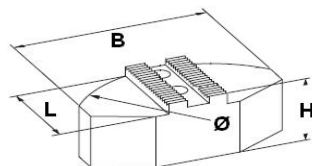

**Segmentbacken, Ø 3 Backen = 250mm / Pie Jaws Ø 3 Jaws = 250mm**

L	B	H	Material	kg	article no.
90	180	60	Stahl / steel	12.30	KPJ-10
90	180	78	Aluminium	6.70	KPJ-10-A

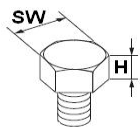

**Auflagebolzen M8 (M10) / Screws for gripper jaws M8 (M10)**

H	SW	Gewinde / thread	kg	article no.
5	13	M8 / ( M10)	0.04	KWS-58 (KWS-510)
10	13	M8 / ( M10)	0.06	KWS-108 (KWS-1010)
15	13	M8 / ( M10)	0.07	KWS-158 (KWS-1510)
20	13	M8 / ( M10)	0.08	KWS-208 (KWS-2010)

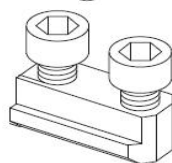

**Doppelte Nutensteine passend für B-210 / Double T-Nuts for B-210**

kg	article no.
0.36	TNS-B210

Version : 07/2013

Druckfehler, Irrtümer und Änderungen vorbehalten / Misprints and errors excepted

# **kitagawa** **EUROPE** **B-210** **Accessories**



Chuck size	10" (254mm)
Bore size	75mm
Gripping force kN (kgf)	111 (11319)
Jaw stroke (diameter)	8.8mm
Plunger Stroke	19mm
Matching cylinder	S1875

Part	Description	
EJ-B210	Dust Cover Ejector	
BUNG-B210	Chuck Bung	
KJB-10 KTL-160	Jaw Boring Ring	
GREASE 400g	400g Grease Cartridge	
GUN-K5PRO	Grease Gun	
KGFM-72	Dynamic Grip Meter 72mm	
KGFM-125	Dynamic Grip Meter 125mm	
DN-B210	Blank Drawtube Connector	
DR-B210	Threaded Drawtube Connector	
CV-B210	Cover Plate	