

Futtertyp / Chucktype: **B-208**
 Hersteller / Maker: **Kitagawa**
 Nutbreite / Slot width: **14 mm**
 Verzahnung / Serration: **1,5x60°**

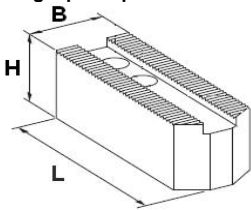

Angespitzt / pointed



Weiche Aufsatzbacken / Soft Top Jaws					Satz = 3 Stück / Set = 3 pieces
L	B	H	kg	article no.	
95	35	35	2.10	KSJ-08-P	
102	35	40	2.70	KSJ-08L-102-P	
120	40	40	3.90	KSJ-08L-120-P	
95	40	40	2.85	KSJ-08W-40x40-P	
95	50	50	4.50	KSJ-08W-50x50-P	
95	35	50	3.30	KSJ-08H-50-P	
95	35	60	3.45	KSJ-08H-60-P	
95	35	80	4.80	KSJ-08H-80-P	

Flach / Flat

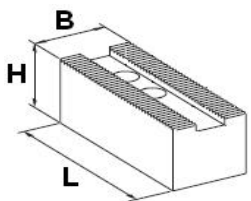

Weiche Aufsatzbacken / Soft Top Jaws					Satz = 3 Stück / Set = 3 pieces
L	B	H	kg	article no.	
95	35	35	2.10	KSJ-08-F	
140	40	40	4.20	KSJ-08L-140-F	
95	60	40	3.60	KSJ-08W-60x40-F	
95	35	100	5.55	KSJ-08H-100-F	
95	35	120	6.30	KSJ-08H-120-F	

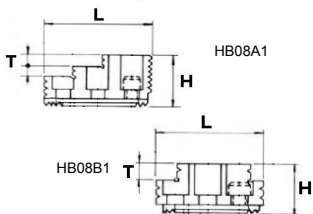

Gehärtete umkehrbare Stufenbacken / Hard top reversible jaws step type						Satz = 3 Stück / Set = 3 pieces
L	B	H	T	kg	article no.	
92	35	51	18	5.70	HB08B1	
86	35	51	12	5.40	HB08A1	

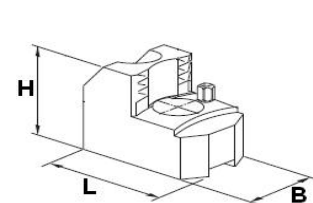

Gehärtete Greiferbacken / Hard top gripper jaws							Satz = 3 Stück / Set = 3 pieces
L	B	H	Spannbereich / gripping range	kg	article no.	€/ Satz / set	
91	35	49	30-60 mm	2.00	KGJ-08-3060		
80	35	49	60-90 mm	1.80	KGJ-08-6090		
68	40	58	90-120 mm	1.65	KGJ-08-9012		
65	40	58	120-150 mm	1.94	KGJ-08-1215		
89	45	59	150-210 mm	2.00	KGJ-08-1521		

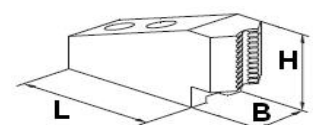

Gehärtete Greiferbacken für kleine Durchmesser / Hard top gripper jaws for small diameters						Satz = 3 Stück / Set = 3 pieces
L	B	H	Spannbereich / gripping range	kg	article no.	
94	35	46	4-15 mm	1.45	KGJ-08-0415	
90	35	49	15-35 mm	1.35	KGJ-08-1535	

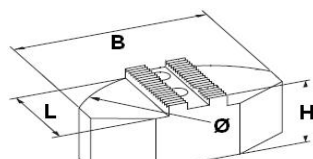

Segmentbacken, Ø 3 Backen = 210mm / Pie Jaws Ø 3 Jaws = 210mm					Satz = 3 Stück / Set = 3 pieces
L	B	H	Material	kg	article no.
75	140	50	Stahl / steel	6.90	KPJ-08
75	140	50	Aluminium	3.00	KPJ-08-A

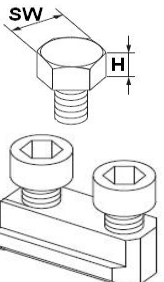

Auflagebolzen M6 / Screws for gripper jaws M6				Satz = 3 Stück / Set = 3 pieces
H	SW	kg	article no.	
5	10	0.03	KWS-56	
10	10	0.04	KWS-106	
15	10	0.04	KWS-156	
20	10	0.06	KWS-206	

Doppelte Nutensteine passend für B-208 / Double T-Nuts for B-208		Satz = 3 Stück / Set = 3 pieces
kg	article no.	
0.24	TNS-B208	

Version : 07/2013

Druckfehler, Irrtümer und Änderungen vorbehalten / Misprints and errors excepted

kitagawa **EUROPE** **B-208** **Accessories**



Chuck size	8" (210mm)
Bore size	52mm
Gripping force kN (kgf)	86 (8769)
Jaw stroke (diameter)	7.4mm
Plunger Stroke	16mm
Matching cylinder	S1552

Part	Description	
EJ-B208	Dust Cover Ejector	
BUNG-B208	Chuck Bung	
KJB-08 KTL-125	Jaw Boring Ring	
GREASE 400g	400g Grease Cartridge	
GUN-K5PRO	Grease Gun	
KGFM-72	Dynamic Grip Meter 72mm	
KGFM-125	Dynamic Grip Meter 125mm	
DN-B208	Blank Drawtube Connector	
DR-B208	Threaded Drawtube Connector	
CV-B208	Cover Plate	