

Futtertyp / Chucktype: **B-206**
 Hersteller / Maker: **Kitagawa**
 Nutbreite / Slot width: **12 mm**
 Verzahnung / Serration: **1,5x60°**

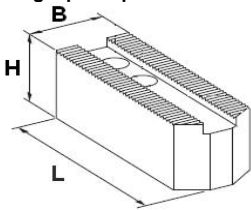

Angespitzt / pointed



Weiche Aufsatzbacken / Soft Top Jaws					Satz = 3 Stück / Set = 3 pieces
L	B	H	kg	article no.	
72	30	30	0.90	KSJ-06-P	
82	30	30	1.20	KSJ-06L-82-P	
72	35	35	1.35	KSJ-06W-35x35-P	
72	50	50	3.60	KSJ-06W-50x50-P	
72	30	50	2.00	KSJ-06H-50-P	
72	30	60	1.95	KSJ-06H-60-P	

Flach / Flat

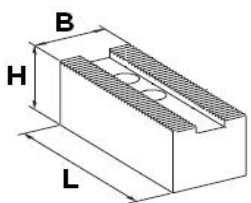

Weiche Aufsatzbacken / Soft Top Jaws					Satz = 3 Stück / Set = 3 pieces
L	B	H	kg	article no.	
72	30	30	0.90	KSJ-06-F	
72	30	80	2.70	KSJ-06H-80-F	
72	30	100	3.30	KSJ-06H-100-F	

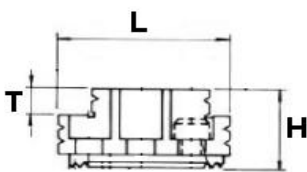

Gehärtete umkehrbare Stufenbacken / Hard top reversible jaws step type						Satz = 3 Stück / Set = 3 pieces
L	B	H	T	kg	article no.	
67.5	31	35	12	2.70	HB06B1	

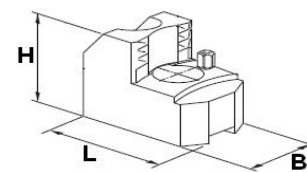

Gehärtete Greiferbacken / Hard top gripper jaws						Satz = 3 Stück / Set = 3 pieces
L	B	H	Spannbereich / gripping range	kg	article no.	
76	30	40	30-50 mm	1.00	KGJ-06-3050	
68	30	40	50-70 mm	0.90	KGJ-06-5070	
63	35	50	70-90 mm	1.10	KGJ-06-7090	
58	40	50	90-110 mm	1.50	KGJ-06-9011	
63	40	50	110-130 mm	1.60	KGJ-06-1113	

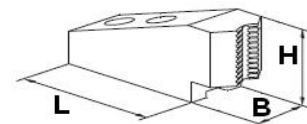

Gehärtete Greiferbacken für kleine Durchmesser / Hard top gripper jaws for small diameters						Satz = 3 Stück / Set = 3 pieces
L	B	H	Spannbereich / gripping range	kg	article no.	
79	30	40	4-15 mm	1.30	KGJ-06-0415	
75	30	40	15-30 mm	1.20	KGJ-06-1530	

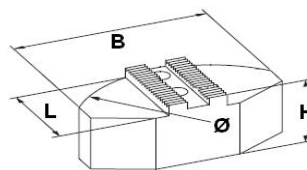

Segmentbacken, Ø 3 Backen = 165mm / Pie Jaws Ø 3 Jaws = 165mm						Satz = 3 Stück / Set = 3 pieces
L	B	H	Material	kg	article no.	
60	120	40	Stahl / steel	3.20	KPJ-06	
60	120	49	Aluminium	1.70	KPJ-06-A	

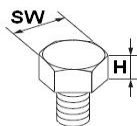

Auflagebolzen M10 / Screws for gripper jaws M10				Satz = 3 Stück / Set = 3 pieces
H	SW	kg	article no.	
5	10	0.03	KWS-56	
10	10	0.04	KWS-106	
15	10	0.04	KWS-156	
20	10	0.06	KWS-206	

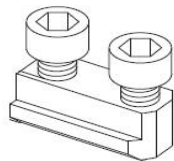

Doppelte Nutensteine passend für B-206 / Double T-Nuts for B-206			Satz = 3 Stück / Set = 3 pieces
kg	article no.		
0.15	TNS-B206		

Version : 07/2013

Druckfehler, Irrtümer und Änderungen vorbehalten / Misprints and errors excepted

Kitagawa

EUROPE

B-206

Accessories



Chuck size	6" (169mm)
Bore size	45mm
Gripping force kN (kgf)	57 (5812)
Jaw stroke (diameter)	5.5mm
Plunger Stroke	12mm
Matching cylinder	S1246

Part	Description	
EJ-B206	Dust cover ejector	
BUNG-B206	Chuck Bung	
KJB06, KTL-100	Jaw Boring Ring	
GREASE 400g	400g Grease cartridge	
GUN-K5PRO	Grease Gun	
KGFM-72	Dynamic Grip Meter 72mm	
KGFM-125	Dynamic Grip Meter 125mm	
DN-B206	Blank Drawtube Connector	
DR-B206	Threaded drawtube connector	
CV-B206	Cover Plate	